



3 bedroom Apartment in Benalmdena

Ref: N7450

452,000€



6053_MR_230209_E003

Superficie Construida	
Vivienda Construida m ²	87,92 m ²
Vivienda constr. incl. + P.T. Zona Común	112,21 m ²
Terraza cubierta	38,72 m ²
Terraza descubierta	11,72 m ²
Construcción total exterior	21,94 m ²
Superficie Útil	
Receptor	3,85 m ²
Baño	3,52 m ²
Baño principal	3,52 m ²
Dormitorio 3	10,66 m ²
Dormitorio 2	9,92 m ²
Dormitorio Principal	15,04 m ²
Pasillo	3,25 m ²
Lavadero	1,22 m ²
Salón/Comedor/Cocina	35,96 m ²
Superficie construida según Decreto 218/2005	112,17 m²
Superficie útil según Decreto 218/2005	84,38 m²

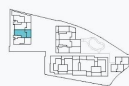

El presente documento es de carácter informativo y podrá ser perfeccionado o modificado por cualquier cambio de condiciones del proyecto, todo el contenido incluido en él de la presente es meramente informativo. Las superficies expresadas pueden experimentar modificaciones por errores de cálculo técnico en el desarrollo de la ejecución de la obra. Las superficies indicadas en continuación están calculadas conforme al decreto 218/2005 de información al consumidor en la construcción y mantenimiento de viviendas de nueva edificación.

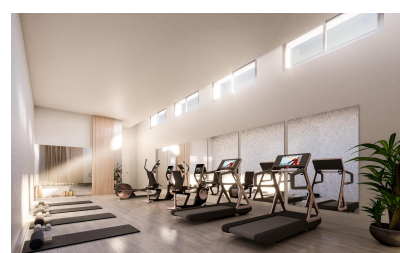

Property type : Apartment

Swimming pool : Communal

House area : 121 m²

Location : Benalmdena

Bedrooms : 3

Bathrooms : 2

✓ Gymnasium

✓ Central heating

✓ Lift

✓ Terrace

Exclusive private urbanisation, with a privileged location in Benalmádena. Due to its elevated location on the slope of the land, each and every one of the 2 and 3 bedroom properties, and 2 townhouses, enjoy incredible views of the sea and the coast. Underfloor heating, aerothermics, armoured door, and lift. Large terraces, bright penthouses and townhouses with private gardens, to experience nature from every corner of your home. Spacious rooms blend into the same environment. Natural light illuminates your bedroom to start the day with the best energy and possibility and all the possibilities. Closed urbanization with communal swimming pool with saline chlorination, spacious green areas. Privileged situation in Benalmádena, less than 20 Km from Málaga and its airport. It has 20 Km of coastline, alternating small bays and cliffs with extensive sandy beaches to enjoy more than 325 days of sunshine a year. Not forgetting its golf courses and the emblematic marina Puerto Marina. The Coastal Path, which runs along the entire coastline, allows you to take long walks along the sea breeze of an infinite sea. Picturesque and traditional villages, excellent gastronomy, which make the Costa del Sol an idyllic and welcoming place for tourism or to establish your permanent residence. Make this idyllic place your own private oasis.